



**Multifaster**

**2P & 3P**

**Hydraulic Inserts**

**Features**



2FFNP  
(Male)



3FFNP  
(Male)

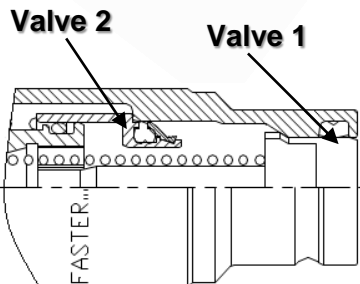

- **The 2P Inserts are owning one single valve.**
- They are connectable under residual pressure only
- During connecting phase the valve will be pushed against the oil volume inside. This creates a continuous pressure increase.
- Considering each different assembly situation (hose length, etc.) a **2P male insert is connectable with max.. 60 bar residual pressure.**

- **3P inserts owning a 2 Valve technology** with integrated mechanical moved shut of valve.
- **A 3P male insert can be connected under working pressure** (with pressure less female side)
- You don't have a pressure increase in the connecting operation.
- **2P and 3P cartridges are interchangeable.**  
**An adjustment of Multifaster for each operating situation is possible every time.**





### Combination 2FFNP – 2FFNB

Connectable under residual pressure with  
0 bar pressure female side open back to tank

**2FFNP Male (max. 60 bar) – 2FFNB Female (0 Bar)**

### Combination 3FFNP – 2FFNB

Connectable under working pressure with  
0 bar female side open back to tank

**3FFNP Male (max. 250 bar) – 2FFNB Female (0 Bar)**

**3FFNP Male (0 bar ) – 2FFNB Female (60 Bar)**

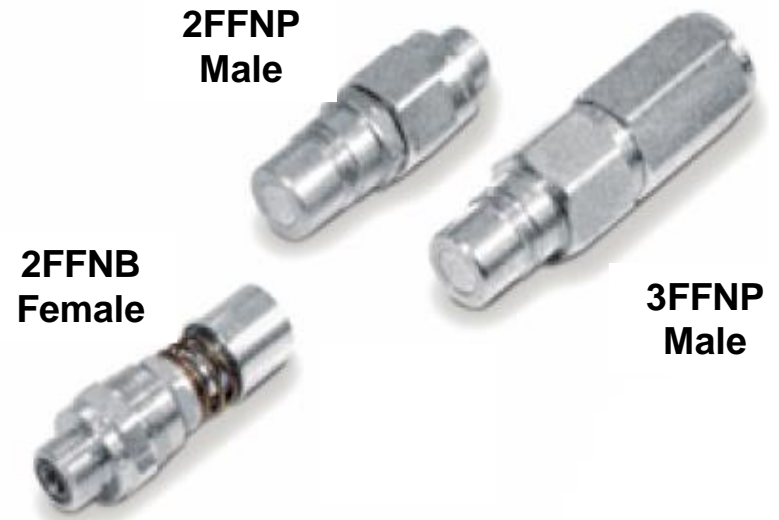

Series  
**2FF<sub>NP</sub>**

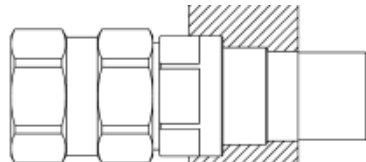

Series  
**3FF<sub>NP</sub>**

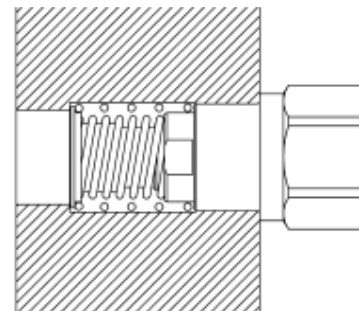
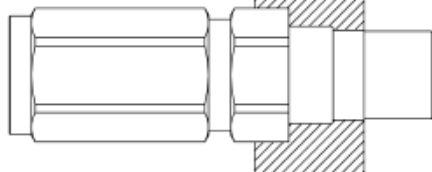

Series  
**2FF<sub>NB</sub>**

